

* STAGE FOUR *

RULES: Practical Shooting Handbook, Latest Edition **COURSE DESIGNER:** GWELBORN

START POSITION: Standing with loaded handgun holstered as per 8.1.1 and 8.1.2. PCC start position is standing with stock on belt, muzzle downrange, loaded carbine held in both hands with safety on. **DOOR OPEN ON START,**

STAGE PROCEDURE	SCORING
<p>On signal engage targets as visible respecting fault lines.</p> <p>All walls, doors, barrels, snow fence walls are hardcover from the ground up unless otherwise specified.</p>	<p>SCORING : Comstock, 30 rounds, 150 points</p> <p>TARGETS: 15 IPSC 0 STEEL</p> <p>SCORED HITS: Best 2 per IPSC, steel down = 1A</p> <p>START-STOP: Audible - Last shot</p> <p>PENALTIES: Procedural. -10 No-shoot hit. -10 Miss. -10</p>

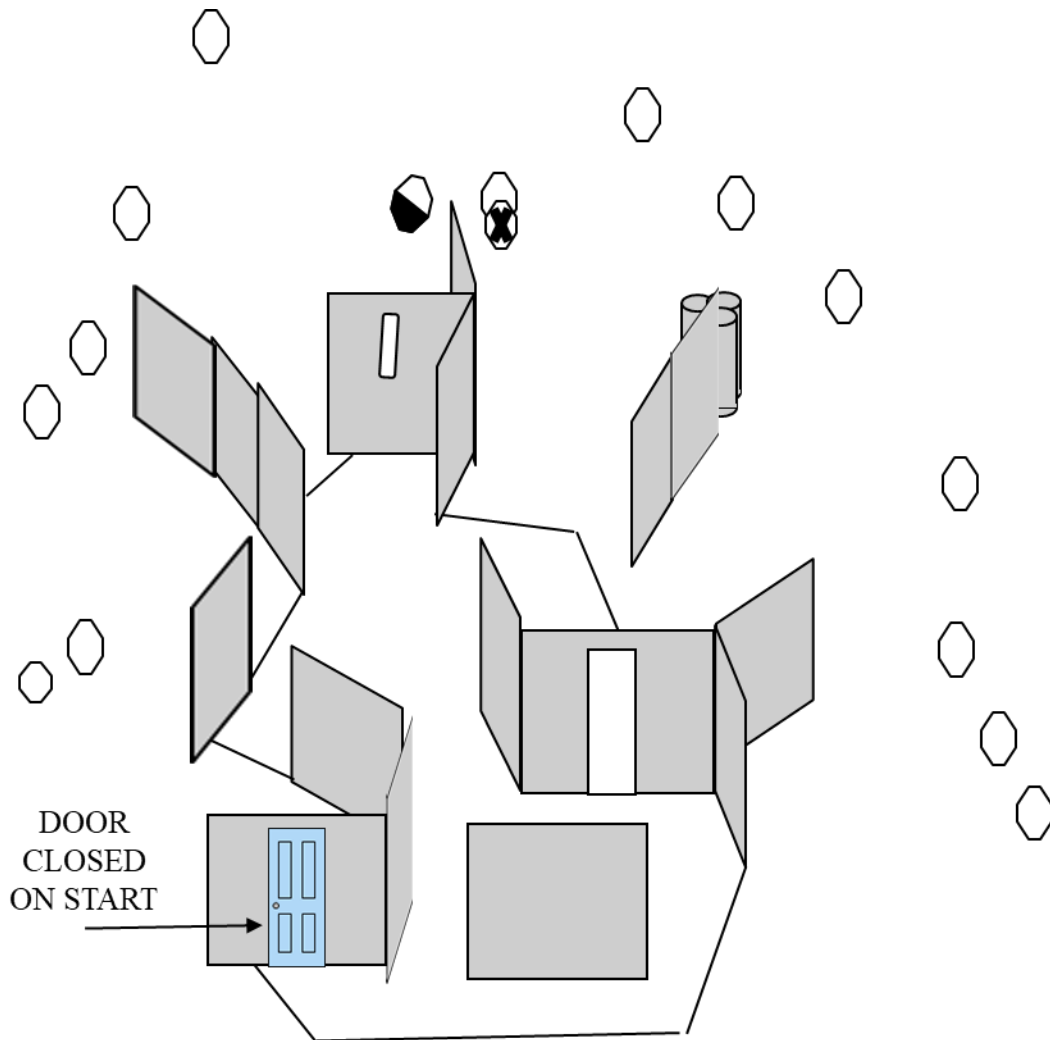

BAY	RO NOTES:
-----	-----------