

# \* STAGE FOUR

**RULES:** Practical Shooting Handbook, Latest Edition **COURSE DESIGNER:** GWELBORN

**START POSITION:** Standing with loaded handgun holstered as per 8.1.1 and 8.1.2. PCC start position is standing with stock on belt, muzzle downrange, loaded carbine held in both hands with safety on. Door open on start.

## STAGE PROCEDURE

On signal engage targets as visible respecting fault lines.

All walls, doors, barrels, snow fence walls are hardcover from the ground up unless otherwise specified.

## SCORING

**SCORING :** Comstock, 31 rounds, 155 points

**TARGETS:** 15 CLASSIC 1 STEEL

**SCORED HITS:** Best 2 per IPSC,  
steel down = 1A

**START-STOP:** Audible - Last shot

**PENALTIES:** Procedural. -10  
No-shoot hit. -10  
Miss. -10

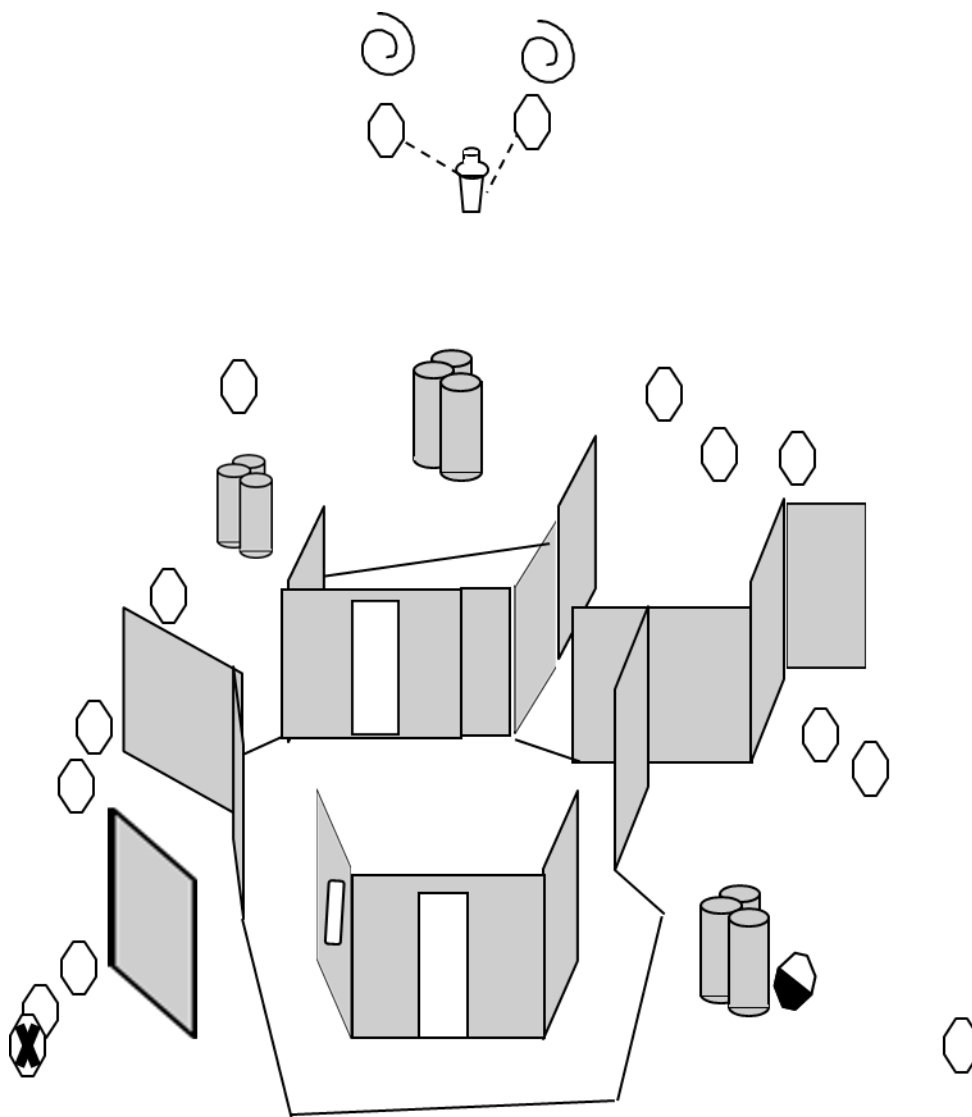

BAY 4

RO NOTES: