

* STAGE FOUR*

RULES: ORPCI MG RULES

COURSE DESIGNER: GWELBORN

START POSITION: Standing with loaded handgun holstered. The loaded rifle is at low ready or in barrel, safety engaged, muzzle down. Door open on start.

STAGE PROCEDURE

On signal engage paper tgts with rifle and/or handgun only. TWO FIREARMS MUST BE USED TO ENGAGE TARGETS. TWO PROCEDURALS FOR FAILURE TO USE TWO FIREARMS.

The firearm in use must be grounded muzzle down in barrel/box prior to retrieving next firearm. Engage all targets respecting fault lines. ONE/TWO/PCC GUN:

All walls, doors, barrels, snow fence walls are hardcover from the ground up unless otherwise specified.

SCORING

SCORING : ORPCI MG Rules

TARGETS: 20 CLASSIC

0 STEEL

SCORED HITS: ORPCI MG Rules

START-STOP: Audible - Last shot

PENALTIES: yes

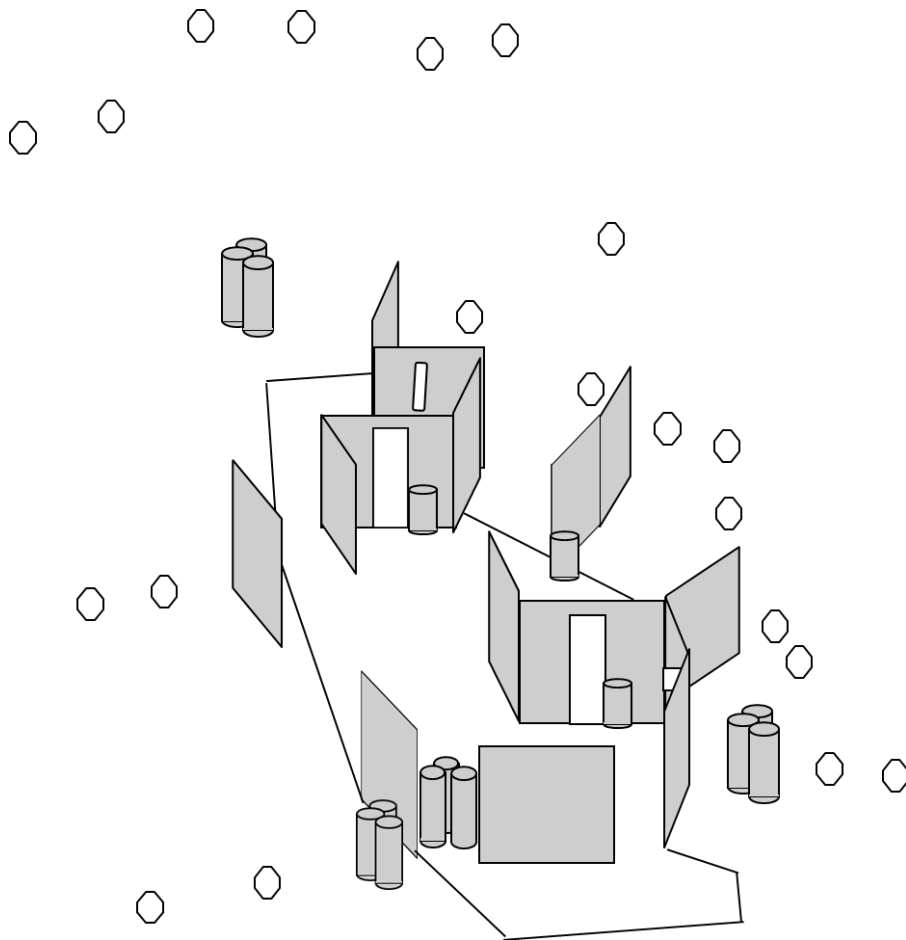

BAY 4

RO NOTES: