

*** MG TWO ***

RULES: ORPCI IMG Rules

COURSE DESIGNER: GWELBORN

START POSITION: Standing with loaded handgun holstered and loaded rifle either at low ready or muzzle down in a dump barrels. Door open on start. (1G Handgun Start = Standing with loaded handgun holstered with hands relaxed at sides. PPC Start = Standing with stock on belt, muzzle downrange, loaded carbine held in both hands with safety on.)

STAGE PROCEDURE

On signal engage ½ scale paper with rifle only. Engage full scale paper with handgun only. The firearm in use must be grounded muzzle down in separate barrel/box prior to retrieving next firearm. Engage all tgts respecting fault lines.

All walls, doors, barrels, snow fence walls are hardcover from the ground up unless otherwise specified.

SCORING

SCORING : ORPCI IMG rules

TARGETS: 8 ½ scale IPSC paper
 - 9 full scale IPSC paper
 -

SCORED HITS: YES

START-STOP: Audible - Last shot

PENALTIES: IMG

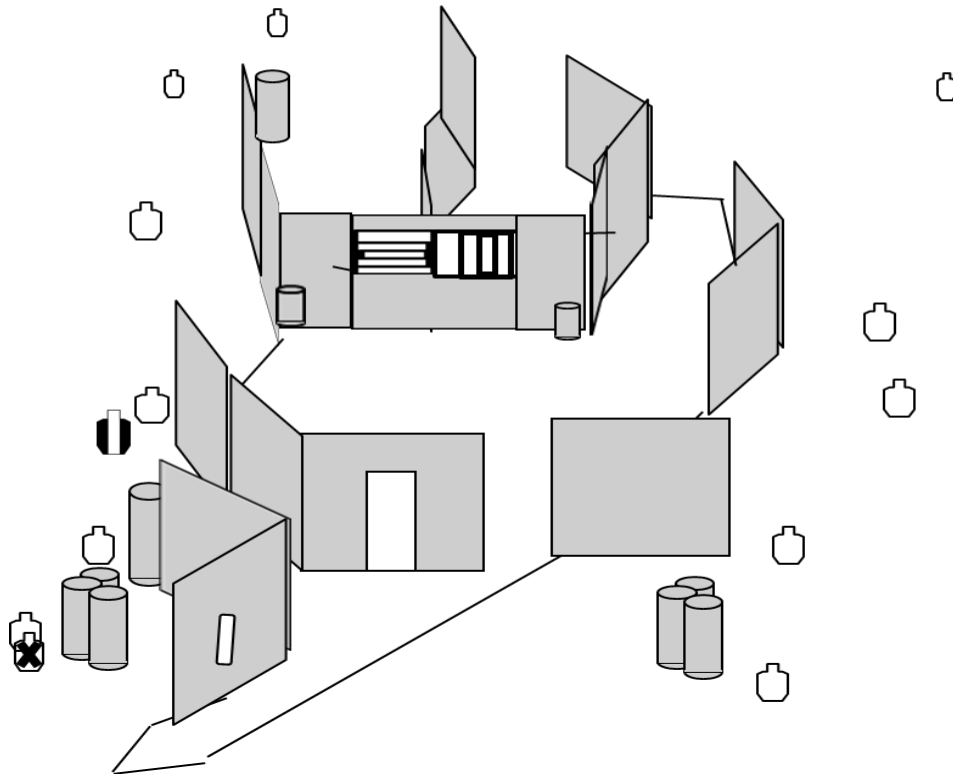
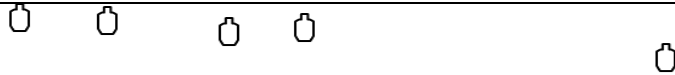

BAY 2 **RO NOTES:**